

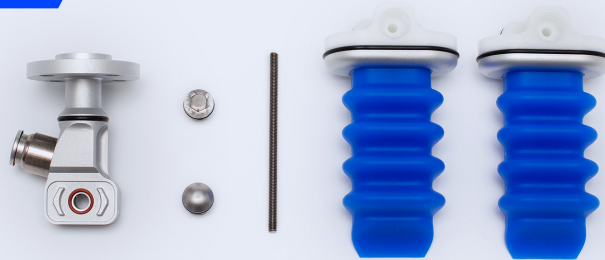

INTRODUCING
mGrip P2 Global Kit

P/N 700159



ADAPT TO THE CHANGING LANDSCAPE

mGrip is an **on-demand, modular gripping system** from Soft Robotics. The *mGrip P2 Global Kit* is purposefully designed to work with a wide variety of robots to fit your needs. This *mGrip* kit enables adaptive handling of unstructured tasks and objects of varying size, shape, and weight. This single, integrated, and easy-to-use solution is perfect for automating applications like:



ASSEMBLY



PICK & PLACE



PACKAGING

The *mGrip P2 Global Kit* is a plug-and-play solution optimized for small to medium sized items. With the modular design and included spacers, you can set your gripper to the ideal stroke size.

PRODUCTION READY

- Time-tested durability
- Accurate task repeatability
- Robot agnostic plug-and-play

REAL-TIME ADAPTABILITY

- Handles variation in item consistency and shape
- Works with multiple SKUs
- Soft gripping material

SEAMLESS INTEGRATION

- Use with industrial and collaborative robots
- No sensor calibration needed
- Modular design to fit your changing needs



SOFT ROBOTICS GRIPPER SYSTEM

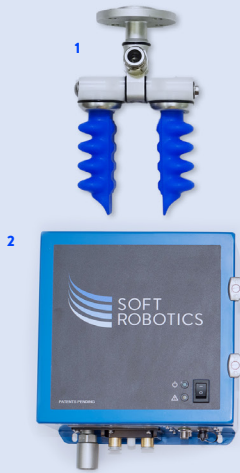

- 1 2 Finger Parallel Tool
 - a • (2) 4 Accordion Finger Modules
 - b • 20mm Robot Adapter
 - c • 10mm Air Fitting
 - d • 2 Finger Parallel Hub
- 2 SR Control Unit, Generation 2

ADAPTABLE HARDWARE

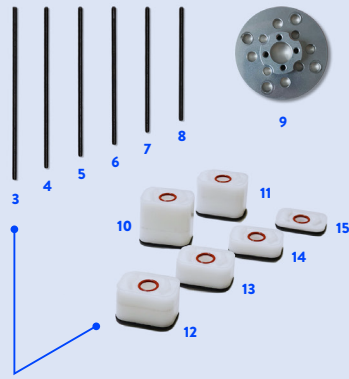

Spacers and Tie Rods enable real-time flexibility to change your grip spacing.

- 3 145mm Tie Rod
- 4 135mm Tie Rod
- 5 125mm Tie Rod
- 6 115mm Tie Rod
- 7 105mm Tie Rod
- 8 95mm Tie Rod
- 9 Omni Disk Flange
- 10 (2) 30mm Spacers
- 11 (2) 25mm Spacers
- 12 (2) 20mm Spacers
- 13 (2) 15mm Spacers
- 14 (2) 10mm Spacers
- 15 (2) 5mm Spacers



GAIN AN EDGE OVER THE COMPETITION WITH SOFT ROBOTICS

Our P2 Gripper paired with our specialized G2 controller allows for 3 to 4 cycles per second.

Do the tasks you need, fast.

All tubing, fittings and relevant hardware are also included.

Specifications

Gripper Mass*	334g
Max Grip Force	2.5lbs per finger
Operating Pressure	2-14psi
Power (for controller)	24V @ 0.5a
Grip Closing Time	73ms
Grip Opening Time	130ms
Air Input	85-100psi input, ISO8573-1:2010[5:5:4]
IP Rating	Designed to IP67
Gripper Spacing	40mm to 100mm

*Represents mass of the gripper as it is configured at time of shipping. Adding spacers will increase mass.

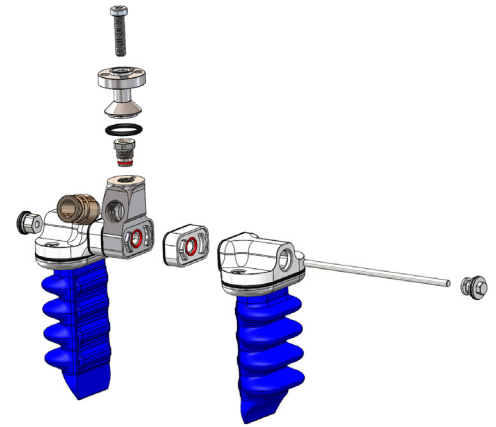

Seeing is believing. For additional information and videos of our gripper in action, visit softroboticsinc.com



Curious to explore the possibilities? Email us at solutions@softroboticsinc.com

WE ARE DRIVING THE FUTURE OF INDUSTRIAL MANUFACTURING.

We believe that it's technology's job to take on the dirty and dangerous jobs. Soft Robotics frees people to do the work that people do best.